



The Anthony A. Leon Guerrero Allied Health Center opened on Dec. 21, 2009, to provide state-of-the-art facilities for GCC's Practical Nursing and Medical Assisting programs, as well as a new science laboratory and computer classrooms.



Guam Community College

A Report to Our Citizens

Fiscal Year 2010

Published May 2011

GCC MISSION

The mission of Guam Community College is to be a leader in career and technical workforce development by providing the highest quality education and job training in Micronesia (Board of Trustees Policy 100).

GCC VISION

GCC will continue to pioneer labor force development within the Western Pacific, best understanding and meeting the educational, career and technical training needs of the economy. It will be Guam's premier career and technical institution and finest secondary and post secondary basic educational institution serving the island's adult community. Its excellence will continue to be recognized because of its service to employers, employees, and the community at large.

ABOUT GUAM COMMUNITY COLLEGE

Guam Community College is a public career and technical education (CTE) institution that operates secondary and postsecondary CTE programs, adult and continuing education, community education, and short-term specialized training, as dictated by community and industry needs. These programs are delivered on campus, in satellite programs at Guam's public high schools, through mayors' offices, and on site at businesses as needed. The College also serves as the State Board of Control for Vocational Education under the United States Vocational Education Acts of 1946, 1963, and subsequent amendments.

INSTITUTIONAL STRATEGIC MASTER PLAN

The 2009-2014 GCC Institutional Strategic Master Plan is a dynamic document that constantly undergoes adjustment as the College expands its programs and increases enrollment. The ISMP's four main components are: Pioneering (identification of the community's career and technical education needs); Educational Excellence (demonstration of Student Learning Outcomes attainment); Community Interaction (improving awareness of the College and garnering public support for its vision); and Dedicated Planning (systematic review of the attainment of GCC vision goals).

FY 10 FINANCIAL HIGHLIGHTS

The College finished Fiscal Year 2010 with a \$4.4 million increase in net assets (a 33% or \$1.1M improvement from FY 2009's \$3.3M increase in net assets). This was due to increased student enrollment, increased Pell student awards and federal grant awards which accounted for an overall 13% increase in revenues. Additionally, the College was able to maintain control over expenditures in line with its revenue increases. The College received an unqualified opinion on both the Financial Statement and Compliance and Internal Controls resulting in the independent auditor's designating the College as a "low-risk" auditee for the 10th consecutive fiscal year. A separate management letter was issued identifying three findings.

ABOUT GCC	1
OUR PROGRAMS	2
OUR FINANCES	3
OUR OUTLOOK	4



Our Programs

Post-Secondary	FA2008	FA2009	FA2010
Full-Time	667	739	865
Part-Time	1,178	1,481	1,677
Total	1,845	2,220	2,542

PS Award of Study	FA2008	FA2009	FA2010
Associate of Arts	255	330	367
Associate of Science	698	854	980
Certificate	171	263	379
AHS Diploma	78	91	77
Industry Certification	7	8	0
Journeyworker Cert	110	173	184
Enrichment	1	5	0
Undeclared	515	496	555
Total	1,835	2,220	2,542

Secondary	FA2008	FA2009	FA2010
George Washington	661	644	714
John F Kennedy	436	435	438
Okkodo	326	318	328
Simon Sanchez	406	403	390
Southern	385	367	398
Total	2,214	2,167	2,268

Adult Education	FA2010
Adult Basic Education	267
Adult Secondary Education	22
English as a Second Language	41
Total	330

Continuing Education	Grand total
July - Sept 2010	2624
Oct - Dec 2010	2416
Jan - Mar 2011	3228
Apr - Jun 2011	Not available
Total	8,268

Total Enrollment	FA2010
Postsecondary	2,542
Secondary	2,268
Apprenticeship	296
Adult Education	330
Continuing Education	8,268
Total	13,704

OUR PROGRAMS

GCC offers over 50 fields of study that prepare students for entry-level employment in career and technical fields or transfer to four-year institutions of higher education. The College also offers community service and special programs to prepare students for college, including English as a Second Language, Adult Basic Education, General Education Development (GED) preparation and testing, and an Adult High School Diploma program. The College expanded its curriculum this year to include two new programs: Associate of Science in Pre-Architectural Drafting, and Certificate in Computer Aided Design & Drafting.

INCREASED ENROLLMENT

During Fall Semester 2010, GCC experienced its third year of consecutive record enrollment, with 2,436 students signing up for classes, a 7.69 percent increase over the fall 2009 enrollment of 2,262 students. Enrollment for fall semester 2009 was 18.75 percent higher than in fall 2008 (1,835 students), which means that in the last two years, GCC has experienced a 26 percent increase in enrollment. Fall 2007 enrollment stood at 1,794 students. GCC attributes this enrollment increase to anticipated competition for the jobs associated with the military buildup.

ACCREDITATION VISIT

Guam Community College has been continuously accredited by the Accrediting Commission for Community and Junior Colleges (ACCJC), Western Association of Schools and Colleges (WASC), since 1979. Documents describing the accreditation may be examined at the Academic Vice President's Office. GCC is currently preparing for the anticipated reaffirmation of its accreditation following an accreditation visit by the ACCJC in March 2012. Also, GCC's Medical Assisting program has been accredited by the Commission on Accreditation of Allied Health Education Programs (CAAHEP) since 2003.

The measures reported on this page were based on compilations from the GCC Office of Assessment, Institutional Effectiveness and Research (AIER). If you would like to see additional information reported, please contact Jayne Flores at the GCC Office of Communications & Promotions at 735-5638 or gcc.pio@guamcc.edu.

Completers	2008	2009	2010	Total
Degree	80	65	114	259
Certificate	53	71	59	183
Adult High School Diploma	12	14	22	48
Criminal Justice Academy	1	30	0	31
External Diploma Program	0	0	2	2
General Education Developmental	135	190	111	436
Journeyworker Certificate	4	40	35	79
Total	285	410	343	1,038

Our Finances

REVENUES

GCC realized a \$3.9M increase in revenues. Federal grants and contracts increased \$1.8M from \$8.1M to \$9.9M due to Pell grant increases, which comprise 66% of student tuition and fees. Capital contributions from the U.S. government increased \$1.4M, from \$943 thousand (K) to \$2.3M. Other revenues increased 108%, or \$904K, from \$841K to \$1.7M mainly due to a Memorandum of Agreement with the Department of Public Health and Social Services to provide training and technical assistance, and outreach support for child care providers.

EXPENDITURES

The increase in GCC's revenues of \$3.9M was offset by a \$2.8M increase in total expenses, which rose from \$26.7M in FY 2009 to \$29.4M in FY 2010. With the increase in student enrollment and federal funding, GCC hired adjunct instructors increasing instruction expenses by \$758K from \$9M to \$9.8M. GCC also incurred more equipment and supply costs resulting in the overall increase in expenditures.

GCC has 227 full-time employees, 13 of whom are funded by federal grants excluding adjunct instructors hired to teach post-secondary courses. Full-time employees increased in FY 2010 by eight employees. As a result, total salaries and wages increased by \$414K from \$15M to \$15.4M.

Complete financial reports and information can be found on our website at www.guamcc.edu.

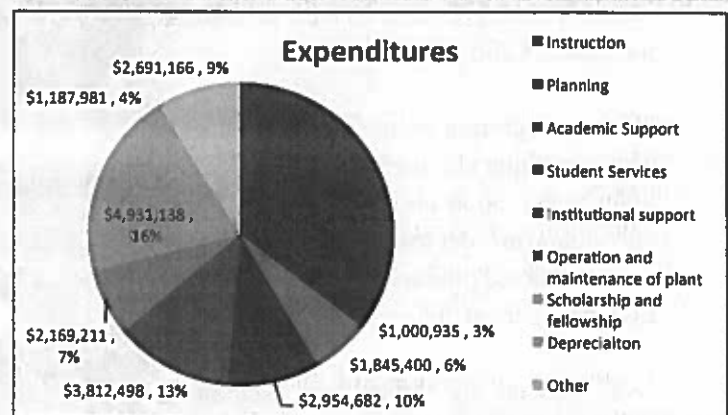
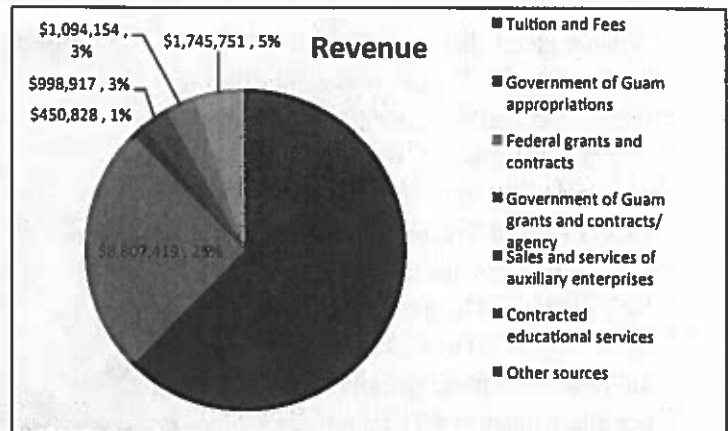

Financial Aid	FA2008	FA2009	FA2010
Number of students receiving financial aid			
PELL	975	1,135	1419
SEOG	157	117	148
FWS	68	78	61
Total financial aid awarded			
PELL	\$2,685,445	\$3,069,949	\$4,464,060
SEOG	\$59,393	\$50,730	\$46,905
FWS	\$79,182	\$84,778	\$63,072
Total	\$2,825,220	\$3,208,787	\$4,575,665

Program Title	FY 10 Award	FY 10 Expenditures
ARRA State Fiscal Stabilization Fund	\$6,000,000	\$170,631
Financial Aid Cluster Program	\$4,592,913	\$4,721,921
Strengthening Minority - Serving Institutions	\$1,065,679	\$1,463,589
Career and Technical Education - Basic Grants to States	\$655,304	\$676,134
Economic, Social, and Political Development of the Territories	\$650,000	\$469,407
College Access Challenge Grant Program	\$1,500,000	\$282,474
Higher Education Institutional Aid	\$400,000	\$278,974
Adult Education - Basic Grants to State	\$394,267	\$259,466
TRIO - Student Support Services	\$313,555	\$252,947
ARRA State Energy Program	\$1,286,000	\$226,396

Our Outlook

A major factor that may affect GCC's short-term outlook is the impending tuition increase for Fall Semester 2011. After having suspended proposed tuition increases for both Fall 2009 and Fall 2010 semesters, the GCC Board of Trustees on March 9, 2011 voted to reinstate the tuition and fee increase for Fall 2011. The increase raises tuition at GCC from \$110 to \$130 per credit hour. A full-time student taking four courses will now pay approximately \$240 more per semester in tuition and \$16 more in fees, for a total increase of \$256 per semester.

"Given our current economic situation, and with everything else increasing around us – utility rates, supply costs – we are forced to raise tuition in order to maintain the quality of our educational product," said Gina Ramos, BOT chairperson, following the vote.

GCC students are thrilled with their new Learning Resource Center, which opened on December 10, 2010. The LRC is the first LEED, or Leadership in Energy and Environmental Design, government of Guam building. Other LEED projects in 2011 include photovoltaic parking lot lights and Allied Health Building projects.

Students are also looking forward to the new Student Center that will sit adjacent to the LRC. The Student Center, which will house student organizations, the Health Office and meeting rooms, is scheduled to open in Fall 2011. Technological additions to the college this year included an Emergency Vehicle Operator Course (EVOC) simulator purchased with Perkins grant funding, and a new Auto CADD lab, used by the PreArchitectural Drafting students and the secondary CTE Auto CADD students.

LEARNING RESOURCE CENTER



STUDENT CENTER

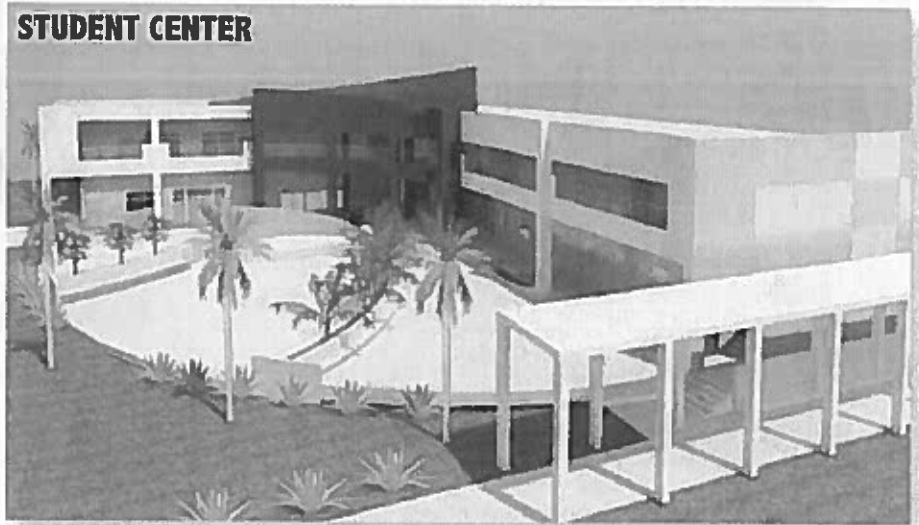

STUDENT CENTER

